

FUEL TANK HONDA CRF 300L 2021 13,5L SERBATOIO HONDA CRF 300L 2021 13,5L

COD. 500008624 REV.1

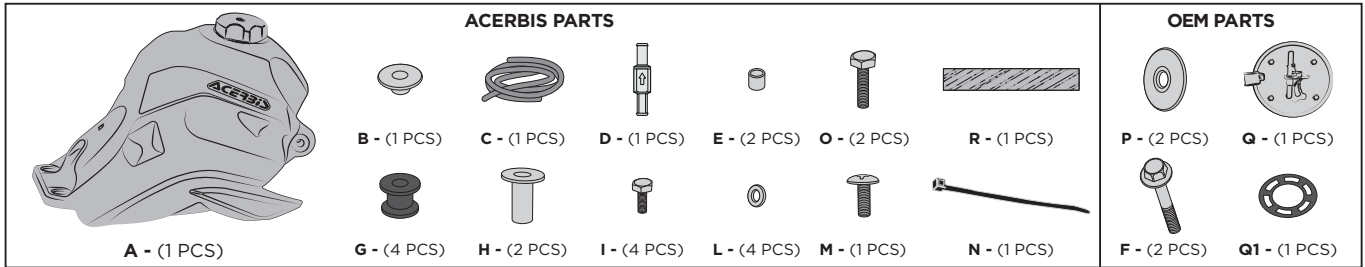

WARNING



Durante il rimontaggio suggeriamo vivamente di utilizzare un grasso anti-grippante sulle viti che entrano negli inserti in metallo.

Highly suggest to use anti-seize/grease lubricant on all bolt threads going into the tank's metal inserts when reinstalling.

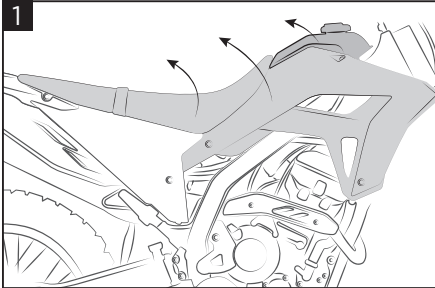

1
Remove the originals side panels, the seat and the tank.
Rimuovere fianchetti, sella e serbatoio originali.

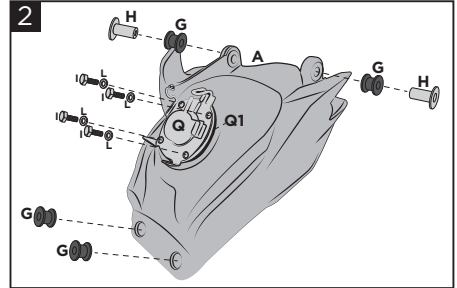

2
After having it removed from the original fuel tank, place the fuel pump (Q) into the Acerbis fuel tank (A), then tighten it using the provided screws (I) and bushings (L). Insert the rubber pads and washers (H) as shown in figure.

Inserire nel serbatoio Acerbis (A) (dopo averla smontata dal serbatoio originale), la pompa (Q) con la guarnizione (Q1) e fissarla tramite le viti (I) e le rondelle (L) in dotazione. Inserire i gommini (G) e le bocche (H) come mostrato in figura.

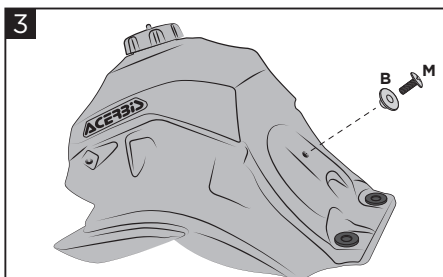

3
insert the bushing (B) and the seat screw (M).
Inserire la boccola (B) e la vite sella (M).

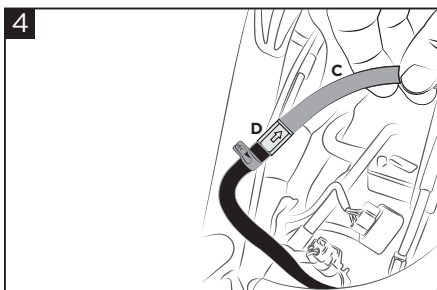

4
Connect the hose (C) to the original carbon canister gas' hose using the valve (D).
Collegare il tubo (C) tramite la valvola (D) al tubo originale dedicato ai gas del carbon canister.

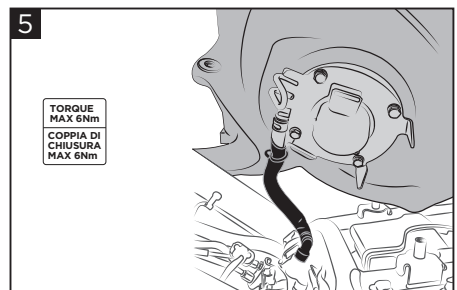

5
Connect the outlets and place the fuel tank on the bike. ATTENTION: when tightening maximum torque spec 6Nm.
Collegare le utenze e posizionare il serbatoio sulla moto. ATTENZIONE: rispettare coppia di chiusura indicata in figura.

TORQUE
MAX 6Nm
COPPIA DI
CHIUSURA
MAX 6Nm

WARNING!

It is **EXTREMELY IMPORTANT** that the fuel tank is properly installed. To ensure proper installation, it is **STRONGLY RECOMMENDED** that the tank is installed only by a qualified OEM licensed dealership mechanic. Improper installation could result in serious injuries or death.

If self-installed **NOTE THE FOLLOWING**: particular attention must be paid to excessive fuel line length and fuel line proximity to hot engine areas and pipes to prevent fire.

Clean tank interior thoroughly before installation. Install this fuel tank only in a well ventilated area, as gasoline fumes are extremely dangerous. Do not start or operate the vehicle if there are any fuel leaks! Read all instructions first before beginning installation.

EUROPE

ACERBIS ITALIA S.P.A.
VIA SERIO, 37
24021 ALBINO (BG)
ITALY

U.S.A.

ACERBIS U.S.A. INC.
MAIL P.O. BOX 2030
SUN VALLEY, ID 83353
SHIP 110 LINDAY CIRCLE
KETCHUM, ID 83340
U.S.A.

UNITED KINGDOM

ACERBIS U.K LTD
UNIT 2 LUTON ENTERPRISE PARK
SUNDON PARK ROAD
LUTON, BEDFORDSHIRE LU3 3GU
GREAT BRITAIN

FUEL TANK HONDA CRF 300L 2021 14L SERBATOIO HONDA CRF 300L 2021 14L

COD. 500008624 REV.1

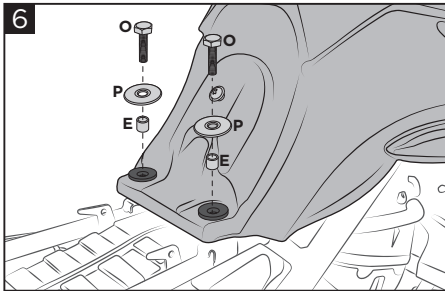

6
Secure the tank's back side by inserting the provided bushings (E) and the original washers (P) and screws (O) inside the rubber pads.

Fissare il serbatoio posteriormente inserendo le boccole in dotazione (E), le rondelle originali (P) e le viti in dotazione (O) nei gommini.

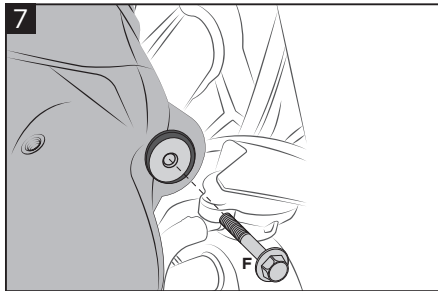

7
Secure the tank's front side using the screws (F).

Fissare il serbatoio anteriormente tramite le viti (F).

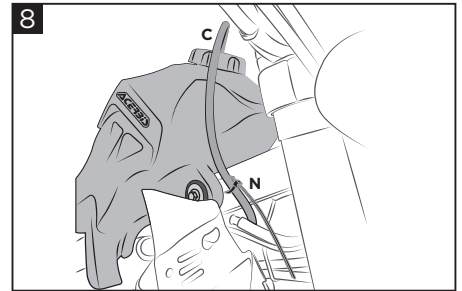

8
Insert the vent hose (C) in the fuel cap and secure it using the zip tie (N) as shown in figure. Reassemble radiator shrouds and seat.
Inserire il tubo sfiato (C) nel tappo e legarlo tramite la fascetta (N) come mostrato in figura.

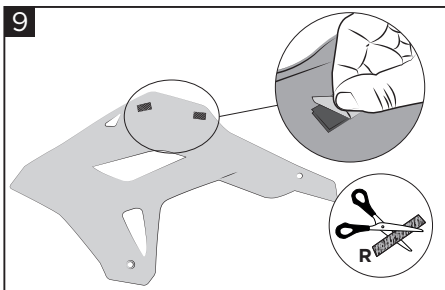

9
Cut the velcro (R) and apply it on the velcro already present on the original side panels, then remove the protective film.

Tagliare il velcro (R) e applicarlo sui velcri già presenti sui fianchetti originali, poi rimuovere la pellicola protettiva.

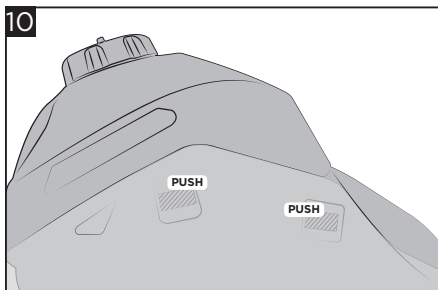

10
Fit the side panels and press in the area of velcro. Finally refit the saddle.

Montare i fianchetti e premere nella zona dei velcri. Infine rimontare la sella.

DISCLAIMER

Due to uncontrolled variables in the manufacturing process of rotational molded fuel tanks, the fuel tank may vary in size and shape by up to 7% of the manufacturer's original listed capacity.

LIBERATORIA

A causa di variabili inponderabili nel processo di stampaggio rotazionale dei serbatoi, questi possono differire in forma e dimensioni fino al 7% rispetto alla capacità dichiarata.

FOR COMPETITION USE ONLY - SOLO PER USO MOTOCICLISTICO

WARNING!

It is **EXTREMELY IMPORTANT** that the fuel tank is properly installed. To ensure proper installation, it is **STRONGLY RECOMMENDED** that the tank is installed only by a qualified OEM licensed dealership mechanic. Improper installation could result in serious injuries or death.

If self-installed **NOTE THE FOLLOWING**: particular attention must be paid to excessive fuel line length and fuel line proximity to hot engine areas and pipes to prevent fire.

Clean tank interior thoroughly before installation. Install this fuel tank only in a well ventilated area, as gasoline fumes are extremely dangerous. Do not start or operate the vehicle if there are any fuel leaks! Read all instructions first before beginning installation.

EUROPE

ACERBIS ITALIA S.P.A.
VIA SERIO, 37
24021 ALBINO (BG)
ITALY

U.S.A.

ACERBIS U.S.A. INC.
MAIL P.O. BOX 2030
SUN VALLEY, ID 83353
SHIP 110 LINDAY CIRCLE
KETCHUM, ID 83340
U.S.A.

UNITED KINGDOM

ACERBIS U.K LTD
UNIT 2 LUTON ENTERPRISE PARK
SUNDON PARK ROAD
LUTON, BEDFORDSHIRE LU3 3GU
GREAT BRITAIN